



15.5×12.3×13.5

YL318

主要特性

- 体积小,重量轻
- 线圈功耗低
- 可直接焊接在印刷线路板
- 适合家用电器、自动化系统,电子设备、
- 仪器、仪表、电信设施和遥控控制系统

触点形式

CONTACT DATA

触点形式	Contact Form	1A(常开)、1B(常闭)、1C(转换)、2A(常开)
触点材料	Contact Material	Silver Alloy
触点负载	Contact Ratings	NO:20A/14VDC 10A/120VAC NC:15A/14VDC 10A/120VAC
最大转换电压	Max.Switching Voltage	30VDC 250VAC
最大转换电流	Max.Switching Current	20A
最大转换功率	Max.Switching Power	280W 1200VA
接触电阻	Contact Resistance	Max 50mΩ
电气寿命	Electrical Life	1×10 ⁵ Ops
机械寿命	Mechanical Life	1×10 ⁷ Ops

性能参数

GENERAL DATA

绝缘电阻	Insulation Resistance	100MΩ (500VDC)		
介质耐压	Dielectric Strength	触点与线圈间耐压	Between coil and contacts	750VAC 50/60Hz 1Min
		触点间耐压	Between open contacts	550VAC 50/60Hz 1Min
吸合时间	Operate Time	Max. 10ms		
释放时间	Release Time	Max. 5ms		
温度范围	Temperature Range	-40°Cto+85°C		
冲击	Shock Resistance	稳定性	Functional	98m/s ²
		强度	Destructive	980m/s ²
振动	Vibration Resistance	10-55Hz Double amplitude 双振幅 1.5mm		
湿度	Humidity	40°C时可达85%		
重量	Weight	约6g		
安规认证	Safety Standard			

线圈参数

COIL DATA

额定电压 Nominal Voltage (VDC)	线圈阻值 Coil Resistance at 20°C ±10%(Ω)		最大吸合电压 Max. Operate Voltage (VDC)	最小释放电压 Min. Release Voltage (VDC)	最大过载电压 Max. Applicable Voltage (VDC)
	0.6W	0.8W			
6	60	45	4.5	0.6	6.6
9	135	101	6.8	0.9	9.9
12	240	180	9.0	1.2	13.2
24	960	720	18	2.4	26.5

■ 订货标记示例

ORDERING INFORMATION

产品型号 Type	YL318	YL318	-C	-12VDC	-D	-XX
触点转换形式 Contact Form	C:1FormC A:1FormA B:1FormB U:2FormA C:1FormC A:1FormA B:1FormB U:2FormA					
线圈电压 Coil Voltage	6V、9V、12V、24V 6V、9V、12V、24V					
线圈功耗 Coil Power	NIL:0.6W D:0.8W 无:0.6W D:0.8W					
特殊参数或特殊要求 Special Parameters Or Special Requirements						

■ 外形图、接线图、安装孔尺寸

OUTLINE DIMENSIONS, WIRING DIAGRAM AND PC BOARD LAYOUT

Dimension(mm)
公差 Tolerance:±0.2

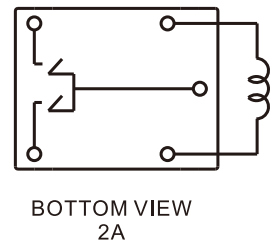
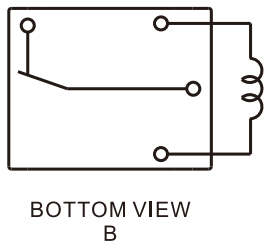
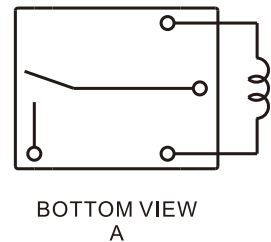
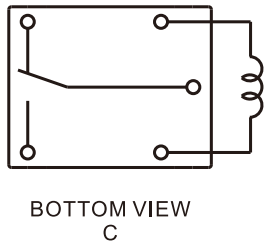
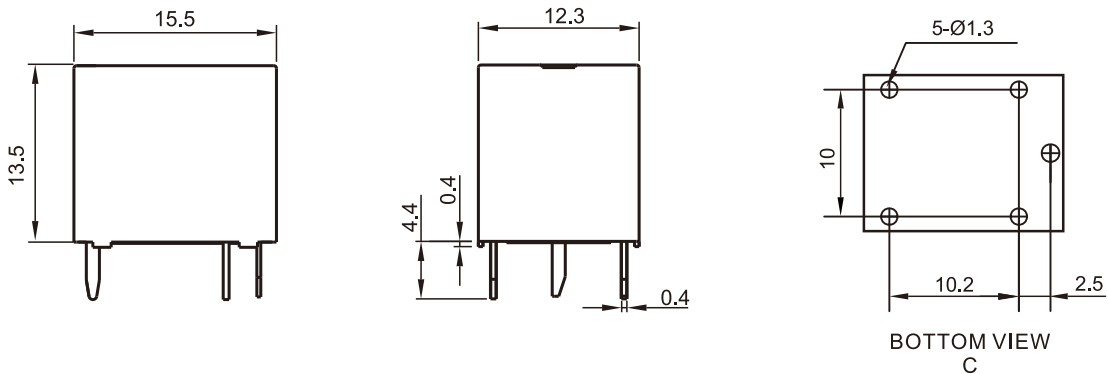

■ 特性曲线

RAEFERENCE DATA

1. 线圈动作电压范围曲线 (常开触点, 13.5VDC负载电压)

Coil operating voltage range(NO contacts,at 13.5VDC)

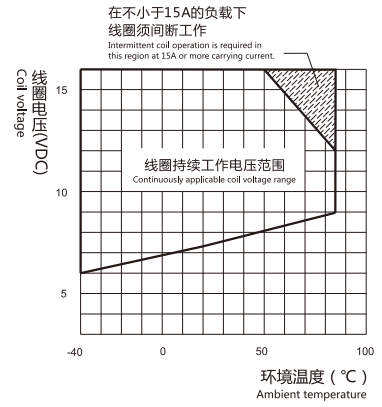
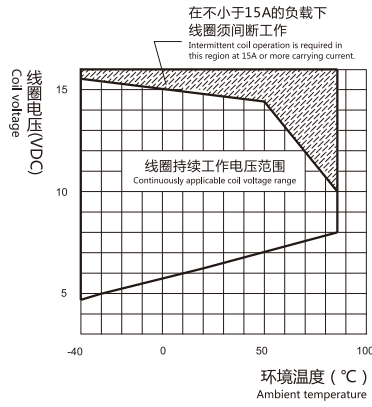
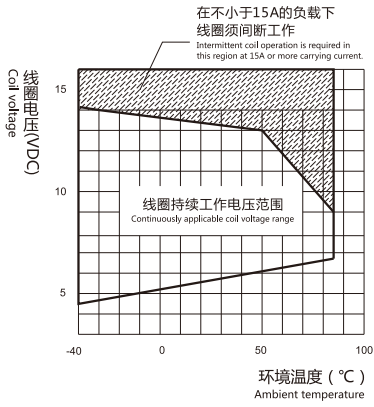

2. 负载曲线 (常开触点, 23°C)

Load curve(NO contacts,at 23°C)

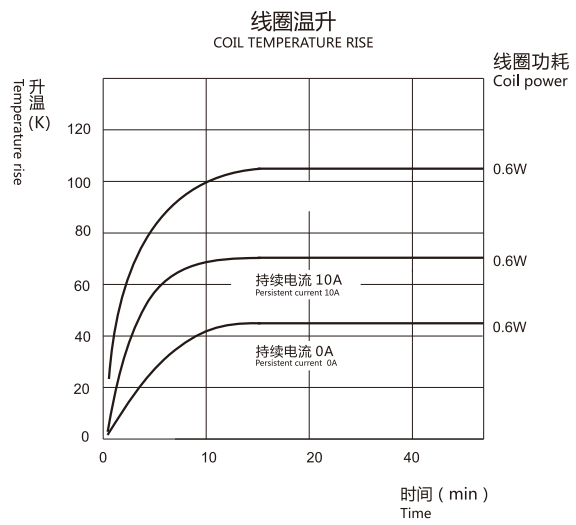
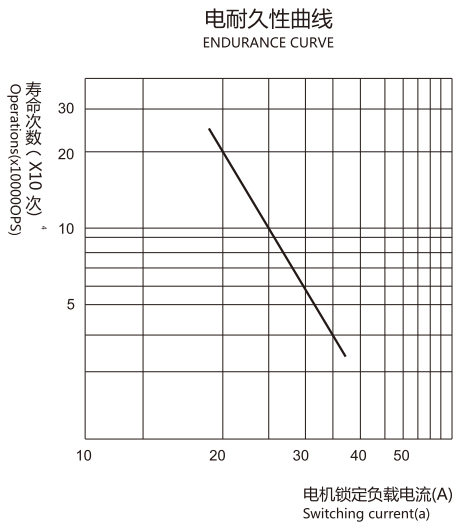

测试条件 Test conditions:

0.2s通, 2s断。
1s ON, 9s OFF.